

RIVERFRONT PARK IS THE LIVING ROOM OF OUR COMMUNITY.

Now it's time to update the Park for the modern Spokane family.

A new Park should connect us—linking north and south, bringing community together at the River and providing meeting and event places that celebrate our history, our bioregion and our people.

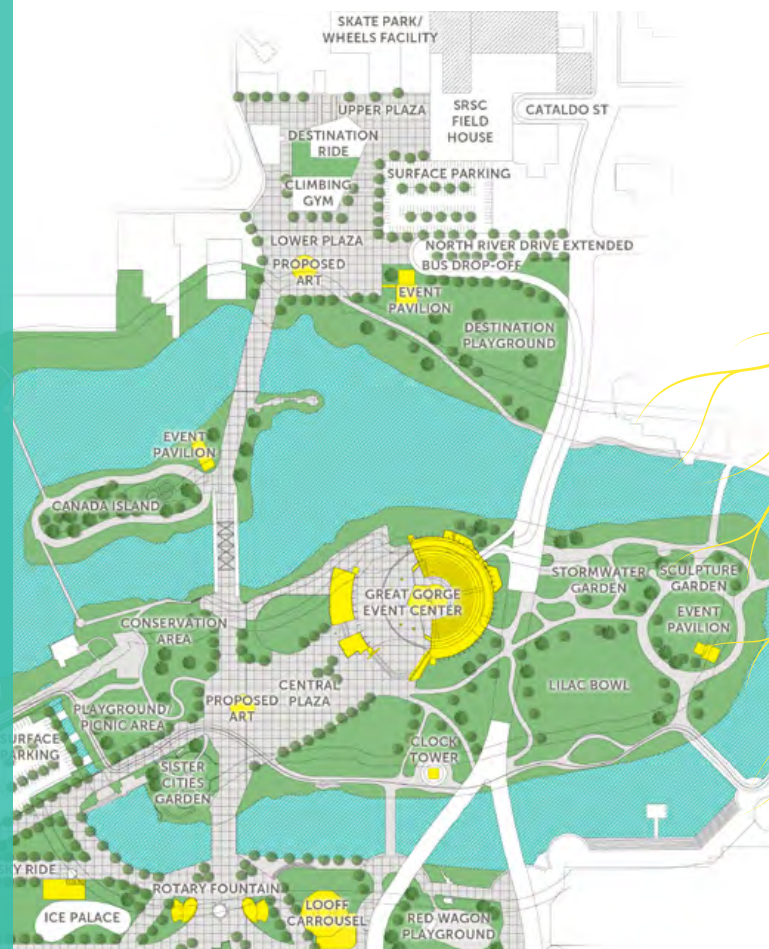

Well-lit, expanded walkway from the Rotary Fountain to the Blue Bridge to the north end:

The Howard Street Promenade aims to be a strong architectural and visual connection through the Park, leading visitors to the center of the Park and to the Spokane River gorge.

The proposed tree-lined Promenade easily accommodates both pedestrian and bicycle traffic, celebrates regional artists, local materials and plantings, and accommodates local vendors ranging from food trucks to market stalls. The Howard Street Promenade along with the Central Plaza on Havermale becomes the town square for our region.

Photos Courtesy - Paul F. Hirzel, Architect

IMAGINE RIVERFRONT

Become the Central Gathering Place for the Region

- Pulling People to the Center
- Increased Visual Access to the River
- Pavilion as the "Lantern for the Community"
- Central Plaza and Pavilion as receptacle for all major events and festivals

Celebrate Community Excellence

- Honor the stories of our shared history
- Highlight the creativity of regional artists

Provide Greater Accessibility to the Park and River

- Improved, upgraded parking lots
- Improved public transit access to the Park's center
- Improved fire, truck and service access

Protection Natural Resources

- Honor the Legacy of EXPO '74 through active stewardship of water, energy, and soils

IMAGINE RIVERFRONT

Create a Healthy Balance between Active & Passive Spaces

- Create spaces for both education and entertainment alongside spaces for reflection
- Preserve and increase green space
- Reduce the amount of buildings within the Park
- Increase viewing platforms and walks along the River

Provide Safety throughout the Park

- Enhanced view corridors
- Enhanced lighting and festival lighting
- Expanded events and programming
- Installation of security cameras & phones

Become a Catalyst for Economic Generation in Spokane

- Incorporate self-sustaining enterprises within the Park
- Provide for expanded revenue and funding streams
- Enhance way-finding and signage throughout the Park

Offer Affordability and Choice to All

- Become a destination for all age groups and income levels
- Offer a variety of programming at little to no cost



Pavilion Event Centers:

Originally built as the U.S. Federal Pavilion for EXPO '74, the Pavilion was a gift to the Spokane region from the United States government. The Master Plan aims to restore the Pavilion into a flexible use event space able to host everything from the Hoopfest Nike Court game and the Bloomsday Awards Ceremony, to a summer concert series and outdoor giant screen film festival.

The proposed conceptual design looks to install a large kinetic dome that can sit within the existing pavilion cable structures. The moveable dome can close when sun or rain protection is needed or rotate open to the sky on a lovely summer night. The dome can also serve as a lantern to the community—glowing with multiple and ever changing imagery—such as basketball players during Hoopfest, or a light show during a concert series with the Spokane Symphony.

The Master Plan also includes upgrades to existing event shelters throughout the Park to better accommodate indoor/outdoor events such as weddings, family reunions, or corporate events. The conceptual design for the three garden pavilions aims to connect these structures in material, style, and lighting to the main pavilion. For events such as First Night, events held and illuminated in the main Pavilion, could be also illuminated in the smaller pavilions utilizing similar light and sound projection techniques.

Photos Courtesy - Olson Kundig Architects

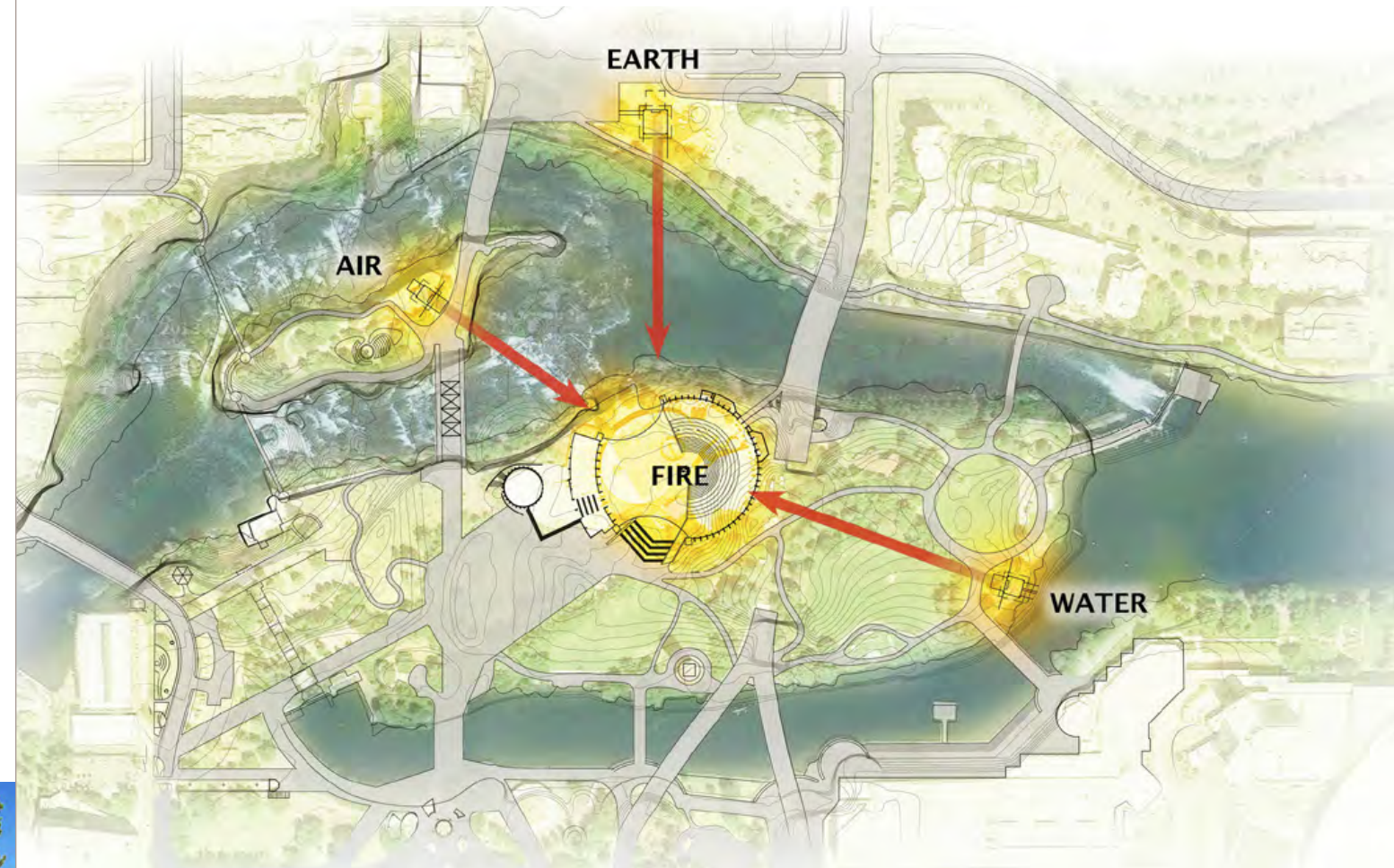

WE
NEED A GREAT
URBAN PARK
THAT
APPEALS TO
ALL AGES.